



Republic of the Philippines

Department of Education
REGION X-NORTHERN MINDANAO
SCHOOLS DIVISION OF LANA O DEL NORTE

DEPED LANA O DEL NORTE	
RECORDS SECTION CONTROL NO. <u>25026</u>	
RELEASED	
01 AUG 2023	3:40
DATE	TIME
BY <u> C </u>	

31 July 2023

DIVISION MEMORANDUM

No. 400, s. 2023

CONSTRUCTION OF POST MOUNTED SCHOOL MARKER OR SIGNAGE

To: All Public Elementary & Secondary School Heads
All Others Concerned

1. This Office informs all schools to construct a school marker or signage for practical and helpful step to improve the visibility of the school's location, especially for visitors or newcomers to the area.
2. Program of Works, Plans, and Specifications is attached as guideline for schools regarding the installation of school markers and signages. Schools should ensure that they comply with these guidelines while considering factors such as safety, accessibility, and visibility.
3. Additional instructions for the construction of the marker or signage:
 - a. Placed near the school's entrance, in a location that is visible from the main road or along the street leading to the school.
 - b. Positioned at an appropriate height for easy viewing.
 - c. Made of durable and weather-resistant materials to withstand various environmental conditions.
 - d. It should not obstruct pedestrian walkways or vehicle traffic.
 - e. Adequate consideration should be given to road safety and traffic regulations during installation.
 - f. Seek necessary permits and approvals from local authorities for the installation of the marker.
 - g. The design and installation should comply with local zoning regulations and guidelines.
 - h. Schools are advised that this project is not included in acquiring infrastructure projects in the MOOE budget. However, the school has the option to utilize alternative funding sources within the school.
4. Immediate dissemination of and strict compliance with this Memorandum is hereby desired.

for Myself
EDWIN R. MARIBOJOC, CESO V
Schools Division Superintendent

Encl. As stated
Reference: As stated
To be indicated in the Perpetual Index

Under the following subjects:
POLICY GUIDELINES POST MOUNTED SCHOOL MARKER OR SIGNAGE DIVISION MEMORANDUM
NGM-MEMORANDUM- CONSTRUCTION OF POST MOUNTED SCHOOL MARKER OR SIGNAGE
July 27, 2023



Address: Pigcarangan, Tubod, Lanao del Norte
Telephone No.: [063] 341-51-09



Management
System
ISO 9001:2015



REPUBLIC OF THE PHILIPPINES
DEPARTMENT OF EDUCATION
Division of Lanao del Norte



PROGRAM OF WORKS
BILL OF QUANTITIES

School :						Date:		
School ID :						Budget Allocation:		
Region : X- NORTHERN MINDANAO						Engineering and Admin. Overhead		
Division : LANA DEL NORTE						Approved Budget for Contract:		
Project Title:						Completion Period:		
						Minimum Required Manpower:		
						General Foreman	Mason	
						Carpenter	Helper	
						Steelman		
						Minimum Required Equipment:		
Location : TANGCAL, LANA DEL NORTE						Hand Tools	Bar Cutter	
						Power Tools	Welding Machine	
ITEM NO.	Item Description	% of Total	Unit	Quantity	Total Cost	Remarks		
I. DIRECT COST								
I.	Post Mounted School Signage with Pedestal							
A.	Earthworks	0.48%	lot	1.00	143.30			
B.	Concreting Works	3.31%	lot	1.00	995.54			
C.	Rebar Works	4.54%	lot	1.00	1,363.21			
D.	Steel Works	18.21%	lot	1.00	5,472.74			
II.	Supply and Fabrication of Reflectorized School Street Signage, 2 Side DIM: 1.55M x 0.75M Using: 2" Post; 10ft Height Reflectorized Sticker gauge 24 Steel Plate	57.75%	lot	1.00	17,355.00			
	Sub-Total				25,329.79			
II. INDIRECT COST % of (I)								
	Overhead Expenses (3 %)	2.53%			759.89			
	Contingencies (2 %)	1.69%			506.60			
	Miscellaneous (3 %)	2.53%			759.89			
	Contractor's Profit (5 %)	4.21%			1,266.49			
	Sub-Total				3,292.87			
	III. TAX _5_%	4.76%			1,431.13			
	IV. TOTAL CONSTRUCTION COST (I + II + III)	100.00%			30,053.80			

Prepared by:

ENGR. NOR-JANAH G. MACASIMPAN
Division Engineer

Recommending Approval:

MARIA CARMELA T. ABLIN
SGOD Chief

Approved:

EDWIN R. MARIBOJOC, CESO V
Schools Division Superintendent



DETAILED COST ESTIMATES

Project Title: Post Mounted School Signage with Pedestal

Location:

Contract No.:

Contractor:

Contract Amount:

ITEM NO.	DESCRIPTION	UNIT	QTY	UNIT COST		TOTAL COST		GRAND TOTAL
				MATERIAL	LABOR	MATERIAL	LABOR	
I.	Post Mounted School Signage with Pedestal							
A.	Earthworks							
	Structural Excavation	cu.m	0.22	-	250.00	-	54.00	54.00
	Backfilling and Compaction	cu.m	0.11	-	275.00	-	30.80	30.80
	Gravel Bedding G-1	cu.m	0.04	1,250.00	375.00	45.00	13.50	58.50
	Sub-total							143.30
B.	Concreting Works							
	Wall Footing	cu.m	0.11					
	Portland Cement	bags	1.00	250.00	75.00	250.00	75.00	325.00
	Crushed Gravel 3/4"	cu.m	0.05	1,450.00	435.00	78.30	23.49	101.79
	Washed Sand	cu.m	0.25	1,750.00	525.00	437.50	131.25	568.75
	Sub-total							995.54
C.	Rebar Works							
	Column & Column Footing, 12mm dia RSB	kg	10.68	72.00	21.60	768.96	230.69	999.65
	Column Ties, 10mm dia RSB	kg	3.70	72.00	21.60	266.54	79.96	346.51
	G.I. Tie Wire	kg	0.16	82.00	24.60	13.12	3.94	17.06
	Sub-total							1,363.21
D.	Steel Works							
	Metal Sheet	pc	0.27	5,400.00	1,620.00	1,441.80	432.54	1,874.34
	G.I. Pipe 2"Ø Sch. 40	pc	2.00	1,384.00	415.20	2,768.00	830.40	3,598.40
	Sub-total							5,472.74
II.	Supply and Fabrication of ReflectORIZED School Street Signage, 2 Side DIM: 1.55M x 0.75M Using: 2" Post; 10ft Height ReflectORIZED Sticker gauge 24 Steel Plate	unit	1.00	13,350.00	4,005.00	13,350.00	4,005.00	17,355.00
	Sub-total							17,355.00
I	DIRECT COST							25,329.79
II	INDIRECT COST % of (I)							3,292.87
III	TAX 5% of (I + II)							1,431.13
IV	TOTAL CONSTRUCTION COST (I + II + III)							30,053.80

Prepared by:

ENGR. NOR-MAHAH G. MACASIMPAN
Division Engineer

Recommending Approval:

MARIA CARMELA T. ABLIN
SGOD Chief

Approved:

EDWIN R. MARIBOJOC, CESO V
Schools Division Superintendent

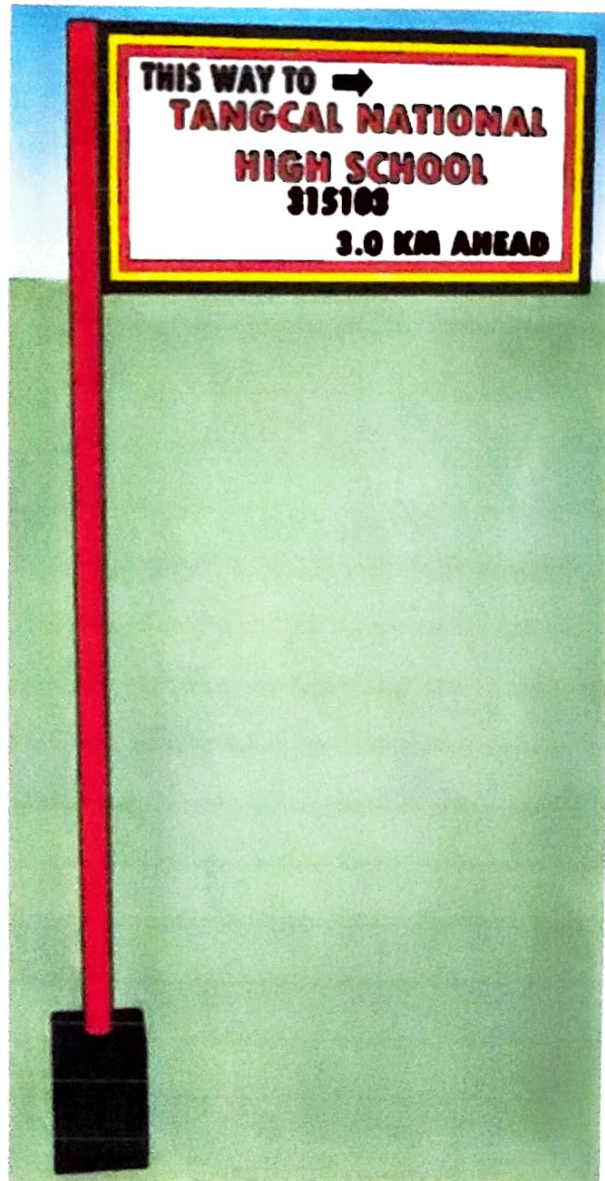

" for one school "

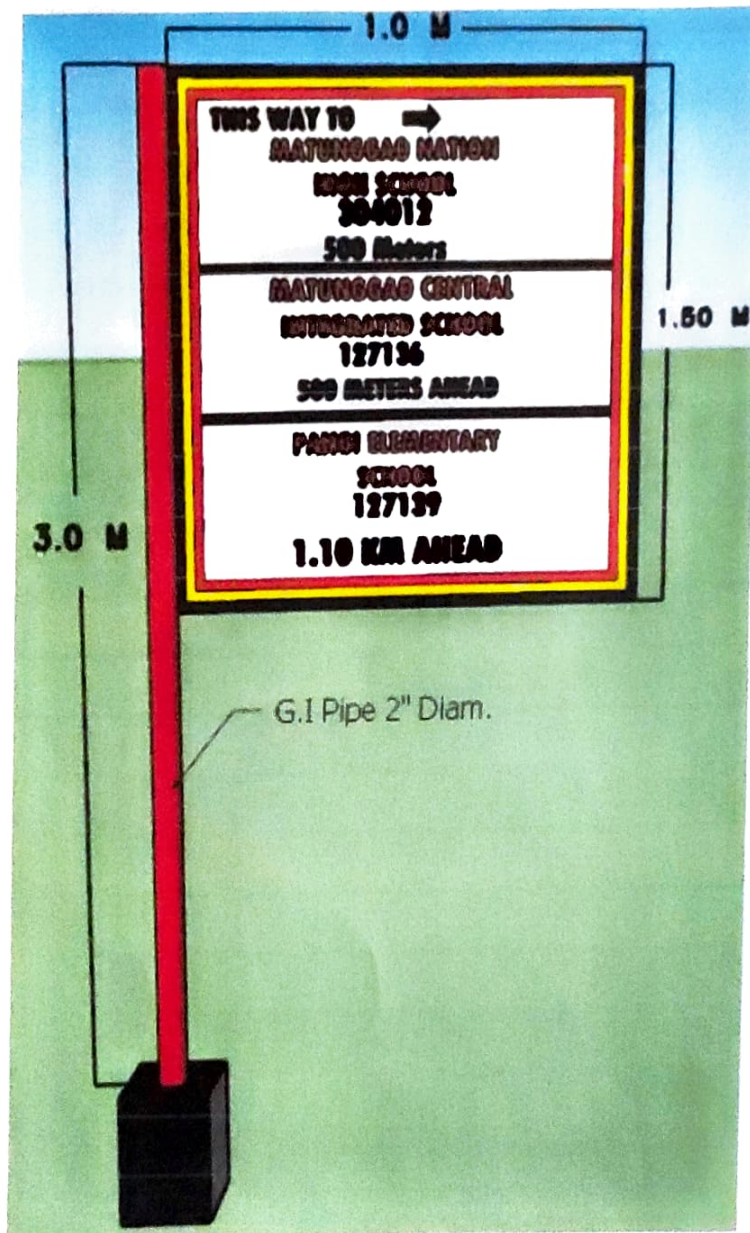

" for more than one school "



PERSPECTIVE

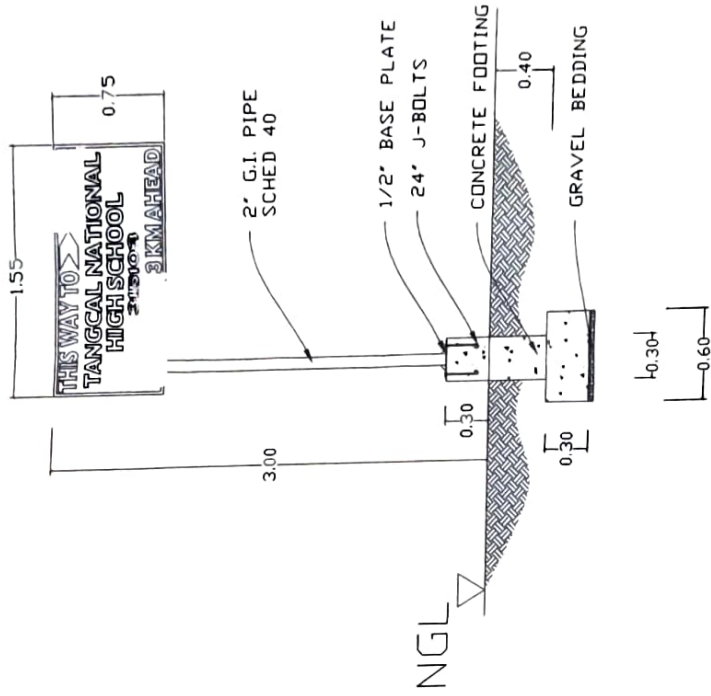

POST MOUNTED
SIGNAGE DETAILS

3" J-BOLTS AND WASHERS
STEEL ANGLE SUPPORTS
STEEL PLATE

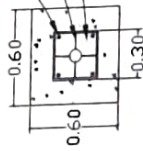

PEDESTAL DETAILS

DESIGNED BY ENR. N. MANABANG, CIVIL ENGINEER	CHECKED BY MARIA CARMITA T. ARIN, CIVIL ENGINEER	APPROVED BY EDWIN M. MARIKON, CIVIL ENGINEER	PROJECT NO. TANGCAL-NHS-SIGNAGE-FIN-001	SHEET NO. 1
---	---	---	--	----------------